

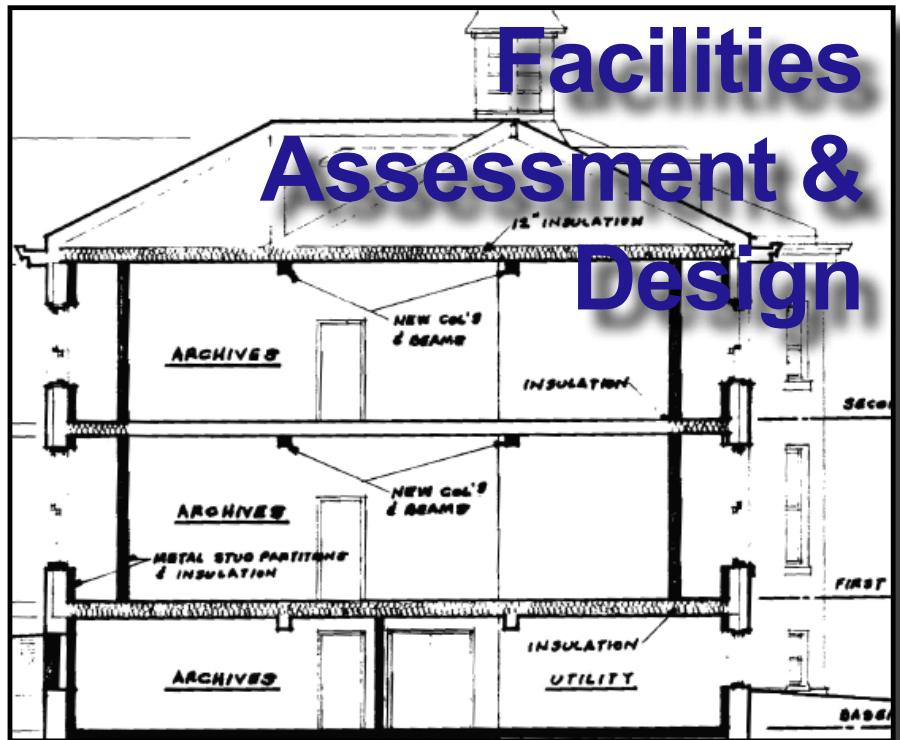

# US Army Corps of Engineers

Mandatory Center of Expertise for the Curation and Management of Archaeological Collections (MCX-CMAC)

To ensure that collections are properly maintained on a national basis, MCX-CMAC can act as a coordinating agency for annual assessments of buildings as well as artifact and archival collections. MCX-CMAC staff members provide expert guidance on specific object type needs such as microenvironmental controls, preservation substances, specialized storage containers, and shelving requirements. MCX-CMAC also provides architectural facilities design for repositories housing federal archaeological, historical, and archival collections. Finally, MCX-CMAC can assist with the coordination of outreach and educational programs.



A team consisting of curatorial experts can assess federal collections facilities, collections, and repositories to ensure that these facilities:

- allow for access by people wishing to examine and study a given collection,
- are designed and organized well enough to find items of interest,
- are adequate to accommodate both people and the materials stored there,
- have protocols and procedures in place that control access to the collections,
- have reliable heating, cooling, and/or humidity controls,
- are built to withstand seismic activity,
- have adequate pest controls, and
- have adequate fire protection devices.

MCX-CMAC facility assessment and design team is likewise capable of working with federal agencies that do not currently have a dedicated curatorial or laboratory facilities, whether those facilities be permanent or expedient (field) in nature. MCX-CMAC may well be the only organization, public or private, that has developed and combined the specialized expertise necessary to design curation facilities for the sole purpose of providing for the long-term care and use of archaeological and historical materials, as well as records and archival collections.

*MCX-CMAC is located at the St. Louis District of the US Army Corps of Engineers.  
For more information, visit our website: [www.usace.army.mil/engr/curation/home](http://www.usace.army.mil/engr/curation/home)*

